

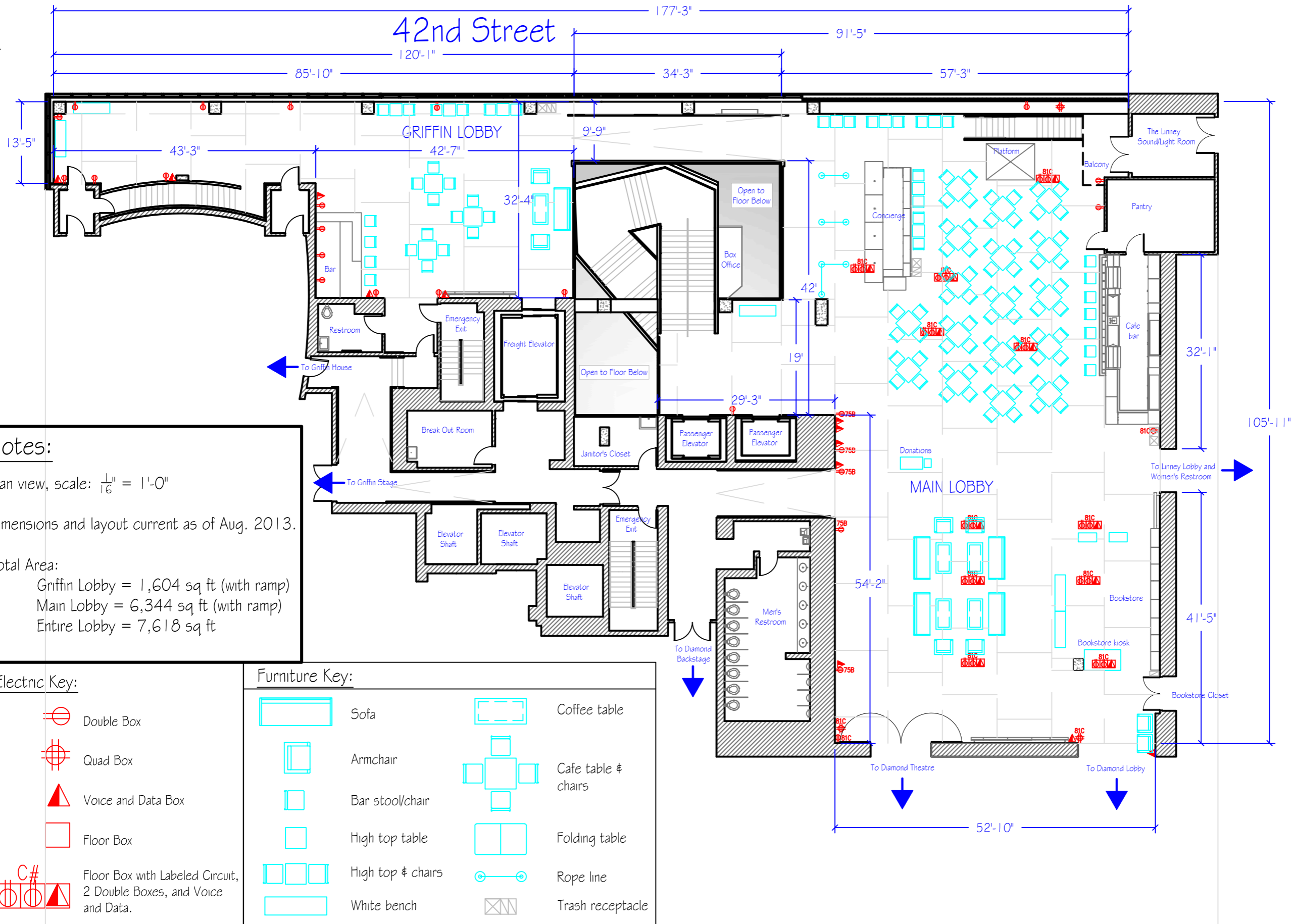

10th Avenue

42nd Street



**Notes:**

Plan view, scale:  $\frac{1}{16}'' = 1'-0''$

Dimensions and layout current as of Aug. 2013.

**Total Area:**

- Griffin Lobby = 1,604 sq ft (with ramp)
- Main Lobby = 6,344 sq ft (with ramp)
- Entire Lobby = 7,618 sq ft

**Electric Key:**

- Double Box
- Quad Box
- Voice and Data Box
- Floor Box
- Floor Box with Labeled Circuit, 2 Double Boxes, and Voice and Data.

**Furniture Key:**

- Sofa
- Armchair
- Bar stool/char
- High top table
- High top & chairs
- White bench
- Coffee table
- Cafe table & chairs
- Folding table
- Rope line
- Trash receptacle

**Signature Theatre**

Original drawing by:	Drew McCallum	Date:	9 - 13 - 12
Revision/furniture layout by:	Alec Strasser	Date:	8 - 19 - 13
Approved by:		Date:	

Plate 1 of 6

The Pershing Square Signature Center

Standard Furniture Layout

212.967.1913  
signaturetheatre.org

480 West 42nd Street  
New York, NY 10036